

# CP2 Exploded Diagram

|    |               |    |                            |    |      |      |    |
|----|---------------|----|----------------------------|----|------|------|----|
| 61 | 内六角平圆头螺钉M5x16 | 1  | Trigger Guard Screw        |    |      |      |    |
| 60 | 护圈            | 1  | Trigger Guard              |    |      |      |    |
| 59 | 吊环销           | 1  | Cliwer Pin                 |    |      |      |    |
| 58 | 吊环            | 1  | Cliwer                     |    |      |      |    |
| 57 | 底盖螺丝          | 1  | Bottom Cap Screw           |    |      |      |    |
| 56 | 底盖            | 1  | Bottom Cap                 |    |      |      |    |
| 55 | 手柄            | 1  | Grip                       |    |      |      |    |
| 54 | 内六角圆柱头螺钉M4x27 | 1  | Piston Cover Screw         |    |      |      |    |
| 53 | 后盖            | 1  | Piston Cover               |    |      |      |    |
| 52 | 活塞弹簧          | 1  | Piston Spring              |    |      |      |    |
| 51 | 活塞            | 1  | Piston                     |    |      |      |    |
| 50 | 气筒组件          | 1  | Air Tube Assembly          |    |      |      |    |
| 49 | 内六角平端头螺钉M3x3  | 1  | Trigger Guard Screw        |    |      |      |    |
| 48 | 阻铁簧           |    | Sear S                     |    |      |      |    |
| 47 | 阻铁            | 1  | Sear                       |    |      |      |    |
| 46 | 扳机            | 1  | Trigger                    |    |      |      |    |
| 45 | 保险            | 1  | Safety                     |    |      |      |    |
| 44 | 扳机销           | 3  | Trigger Pin                |    |      |      |    |
| 43 | 钢珠            | 1  | Steel Ball                 |    |      |      |    |
| 42 | 保险簧           | 1  | Safety Spring              |    |      |      |    |
| 41 | 内六角圆柱头螺钉M4x6  | 1  | Air Tube Screw M4x6        |    |      |      |    |
| 40 | 阀体2           | 1  | Valve2                     |    |      |      |    |
| 39 | 出气阀芯销         | 1  | Exhaust Valve Core Pin     |    |      |      |    |
| 38 | 出气阀芯          | 1  | Exhaust Valve Core         |    |      |      |    |
| 37 | 出气阀芯套         | 1  | Exhaust Valve Core Sleeve  |    |      |      |    |
| 36 | 阀体压簧          | 1  | Valve Spring               |    |      |      |    |
| 35 | 阀体O型圈         | 1  | Valve O-ring               |    |      |      |    |
| 34 | 阀体1           | 1  | Valve 1                    |    |      |      |    |
| 33 | 刺针O型圈         | 1  | Puncture Pin O-ring        |    |      |      |    |
| 32 | 刺针            | 1  | Puncture Pin               |    |      |      |    |
| 31 | 刺针皮碗          | 1  | Puncture Pin Seal          |    |      |      |    |
| 30 | 刺针螺母          | 1  | Puncture Pin Seal          |    |      |      |    |
| 29 | 锁紧套           | 1  | Locking Sleeve             |    |      |      |    |
| 28 | 加力杆           | 1  | Strengthening Rod          |    |      |      |    |
| 27 | 连接套           | 1  | Connector                  |    |      |      |    |
| 26 | 连接套O型圈        | 2  | Connector O-ring           |    |      |      |    |
| 25 | 内六角沉头螺钉M3x5   | 1  | Breech Screw               |    |      |      |    |
| 24 | 强磁光轴2         | 1  | Magnet                     |    |      |      |    |
| 23 | 顶座            | 1  | Breech                     |    |      |      |    |
| 22 | 橡胶球           | 1  | Rubber Ball                |    |      |      |    |
| 21 | 手把            | 1  | Handle                     |    |      |      |    |
| 20 | 内六角圆柱头螺钉M4x6  | 2  | Bolt Screw                 |    |      |      |    |
| 19 | 衬套            | 2  | Bolt Bush                  |    |      |      |    |
| 18 | 拉杆            | 1  | Bolt                       |    |      |      |    |
| 17 | 销钉1.5x13      | 1  | Rear Sight Pin             |    |      |      |    |
| 16 | 照门底座          | 1  | Rear Sight Block           |    |      |      |    |
| 15 | 照门弹簧          | 1  | Rear Sight Spring          |    |      |      |    |
| 14 | 照门            | 1  | Rear Sight                 |    |      |      |    |
| 13 | 开槽圆柱头螺钉M3x6   | 2  | Rear Sight Base Side Screw |    |      |      |    |
| 12 | 照门座           | 1  | Rear Sight Base            |    |      |      |    |
| 11 | 一字平头螺钉        | 1  | Rear Sight Base Screw      |    |      |      |    |
| 10 | 照门固定螺丝        | 2  | Rear Sight Fixing Screw    |    |      |      |    |
| 9  | 强磁光轴1         | 1  | Magnet                     |    |      |      |    |
| 8  | 装弹座           | 1  | Loading Base               |    |      |      |    |
| 7  | 内六角紧定螺钉M4x4   | 1  | Breech Screw M4x4          |    |      |      |    |
| 6  | 内六角平端头螺钉M4x3  | 3  | Breech Screw M4x3          |    |      |      |    |
| 5  | O型圈           | 1  | Barrel Front O-ring        |    |      |      |    |
| 4  | O型圈           | 2  | Barrel Rear O-ring         |    |      |      |    |
| 3  | 枪管            | 1  | Barrel                     |    |      |      |    |
| 2  | 前准星           | 1  | Front Sight                |    |      |      |    |
| 1  | 前准星固定套        | 1  | Front Sight Sleeve         |    |      |      |    |
| 序号 | 代号            | 名称 | 数量                         | 材料 | 单件重量 | 总计重量 | 备注 |

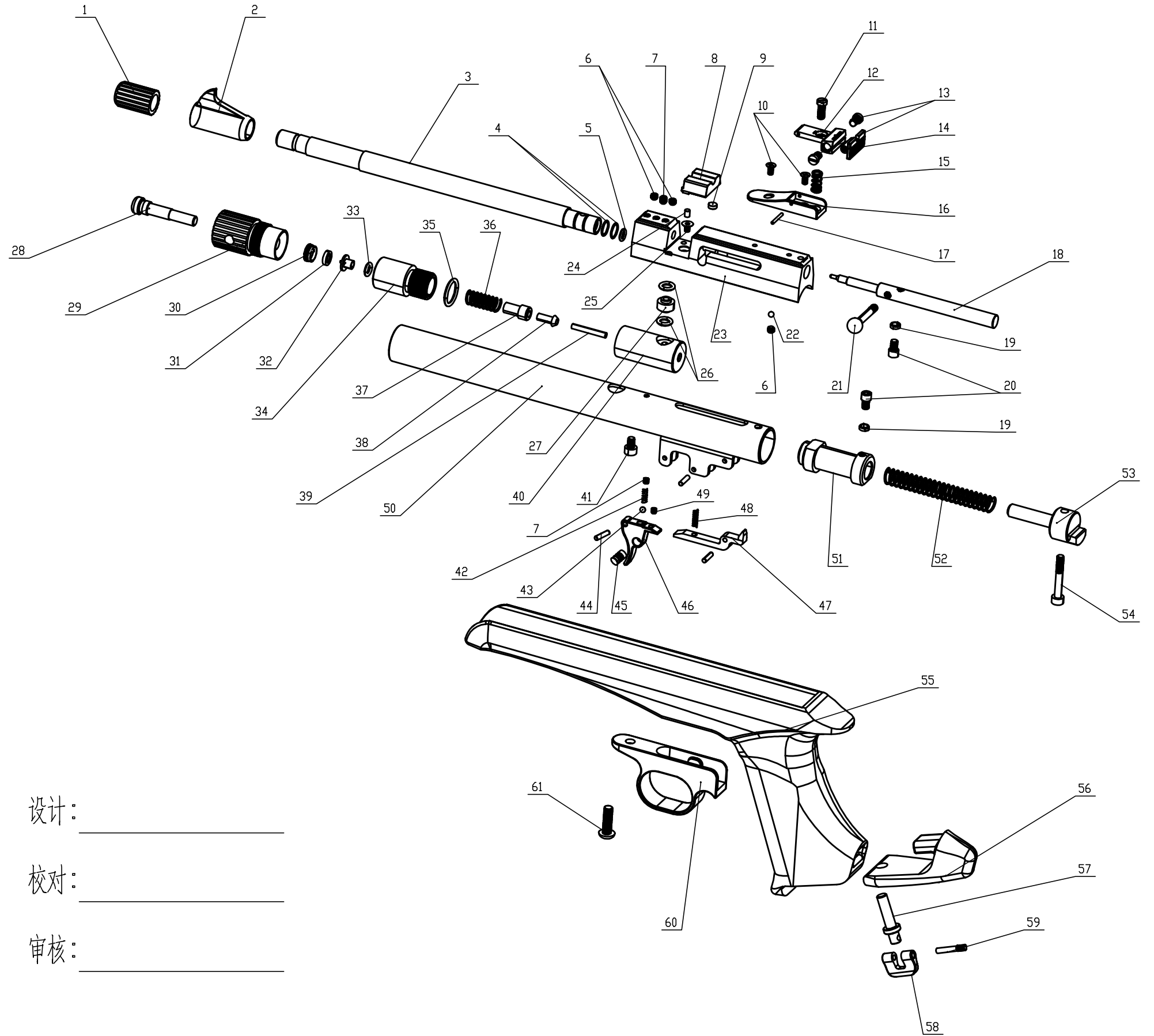

设计: \_\_\_\_\_

校对: \_\_\_\_\_

审核: \_\_\_\_\_